



MINIMATIC® BARB CONNECTORS

All fittings are brass unless otherwise noted, i.e. ENP (Electroless Nickel-Plated)

ENP #10-32 Male to Barb Swivel

(5/pack)

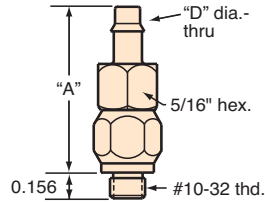

Barb (ID)	Order No.	"A"	#D" Dia.
3/32"	ST3	0.821"	0.052"
1/8"	ST4	0.891"	0.109"

Gasket included, not installed

#10-32 Male to 1/8" I.D. Barb Swivel

(5/pack)

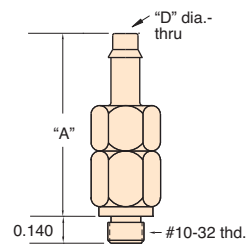

Barb (ID)	Order No.	"A"	"D" Dia.
1/8"	15045	0.762"	0.109"

Not to be used as a constant rotation junction

TIP Most Clippard #10-32 threaded fittings require no more than 9 inch-pounds of torque to seal. We recommend that this force not be exceeded.

ENP #10-32 Female to Barb

(5/pack)

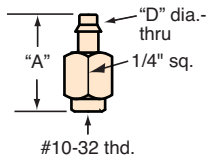

Barb (ID)	Order No.	"A"	"D" Dia.
1/16"	CF2	0.640"	0.052"
3/32"	CF3	0.640"	0.073"
1/8"	CF4	0.718"	0.109"

ENP #10-32 Female to Barb Swivel

(5/pack)

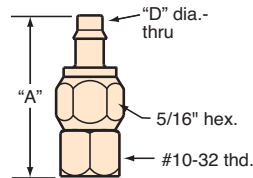

Barb (ID)	Order No.	"A"	"D" Dia.
3/32"	S3F	0.821"	0.052"
1/8"	S4F	0.871"	0.109"

Barb to Barb Connectors

ENP Barb to Barb

(5/pack)

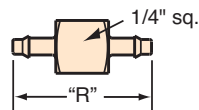

Barb (ID)	Barb (ID)	Order No.	"R"
1/16"	1/16"	C22	0.656"
1/16"	3/32"	C32	0.684"
1/16"	1/8"	C42	0.734"
3/32"	3/32"	C33	0.712"
3/32"	1/8"	C43	0.762"
1/8"	1/8"	C44	0.812"

ENP Barb to Barb Swivel

(5/pack)

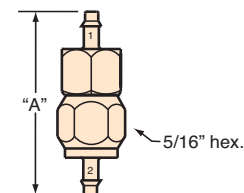

Barb (ID) 1	Barb (ID) 2	Order No.	"A"
3/32"	3/32"	S33	1.052"
1/8"	1/8"	S44	1.183"