

## Economy Floor Mount Base Plate

### Part Description:

The economy floor mount base plate is made of anodized aluminum to withstand daily use and wear and tear. It bolts directly to the T-slot to allow vertical adjustments and is designed with countersunk holes to incorporate floor anchors.

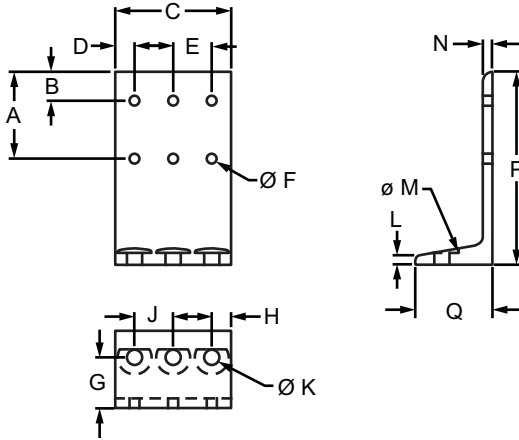

Part No.	Series	Color	A	B	C	D	E	F	G	H
2414	10	Clear	2.250"	.750"	1.000"	.500"	—	.257"	1.312"	.500"
2414-Black	10	Black	2.250"	.750"	1.000"	.500"	—	.257"	1.312"	.500"
2416	10	Clear	2.250"	.750"	2.000"	.500"	1.000"	.257"	1.312"	.500"
2416-Black	10	Black	2.250"	.750"	2.000"	.500"	1.000"	.257"	1.312"	.500"
2404	10	Clear	2.250"	.750"	3.000"	.500"	1.000"	.257"	1.312"	.500"
2404-Black	10	Black	2.250"	.750"	3.000"	.500"	1.000"	.257"	1.312"	.500"
2415	15	Clear	2.250"	.750"	1.500"	.750"	—	.328"	1.312"	.750"
2415-Black	15	Black	2.250"	.750"	1.500"	.750"	—	.328"	1.312"	.750"
2417	15	Clear	2.250"	.750"	3.000"	.750"	1.500"	.328"	1.312"	.750"
2417-Black	15	Black	2.250"	.750"	3.000"	.750"	1.500"	.328"	1.312"	.750"
2405	15	Clear	2.250"	.750"	4.500"	.750"	1.500"	.328"	1.312"	.750"
2405-Black	15	Black	2.250"	.750"	4.500"	.750"	1.500"	.328"	1.312"	.750"
			J	K	L	M	N	P	Q	Weight
2414	10	Clear	—	.390"	.312"	.875"	.250"	5.000"	2.000"	.178 lb
2414-Black	10	Black	—	.390"	.312"	.875"	.250"	5.000"	2.000"	.178 lb
2416	10	Clear	1.000"	.390"	.312"	.875"	.250"	5.000"	2.000"	.270 lb
2416-Black	10	Black	1.000"	.390"	.312"	.875"	.250"	5.000"	2.000"	.270 lb
2404	10	Clear	1.000"	.390"	.312"	.875"	.250"	5.000"	2.000"	.545 lb
2404-Black	10	Black	1.000"	.390"	.312"	.875"	.250"	5.000"	2.000"	.545 lb
2415	15	Clear	—	.531"	.312"	1.125"	.250"	5.000"	2.000"	.263 lb
2415-Black	15	Black	—	.531"	.312"	1.125"	.250"	5.000"	2.000"	.263 lb
2417	15	Clear	1.500"	.531"	.312"	1.125"	.250"	5.000"	2.000"	.545 lb
2417-Black	15	Black	1.500"	.531"	.312"	1.125"	.250"	5.000"	2.000"	.545 lb
2405	15	Clear	1.500"	.531"	.312"	1.125"	.250"	5.000"	2.000"	.785 lb
2405-Black	15	Black	1.500"	.531"	.312"	1.125"	.250"	5.000"	2.000"	.785 lb

CONTINUE