

Deluxe Leveling Foot

Part Description:

The deluxe leveling foot has a jam nut that allows it to pivot 20 degrees to accommodate uneven floors. There are options available with load capacities ranging from 1000-7400 pounds and 317-3357 kilograms. The deluxe leveling foot is a heavy-duty option ideal for large structures. For information on base plates see pages 638-643 and 653-654.

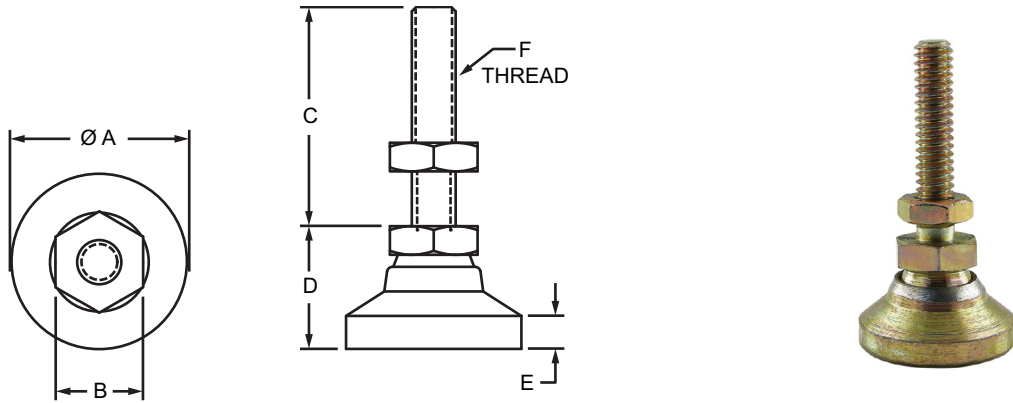

Part No.	Series	Color	A	B	C	D	E	F	Load Capacity	Weight
2192	F	Yellow	1.000"	.500"	1.250"	.703"	.156"	1/4-20	1000.00 lb	.1042 lb
2194	F		1.250"	.625"	2.000"	.875"	.188"	5/16-18	2300.00 lb	.1966 lb
2190	F		1.250"	.625"	2.000"	.875"	.188"	3/8-16	3750.00 lb	.2160 lb
2200	F		1.875"	.750"	2.000"	1.125"	.250"	1/2-13	5000.00 lb	.4940 lb
2202	F		3.000"	1.062"	2.000"	1.500"	.500"	3/4-10	7400.00 lb	1.6930 lb
25-2192	M		19.00mm	10.00mm	25.00mm	14.00mm	2.50mm	M6 x 1.00	317.00 kg	.0213 kg
65-2212	M		26.00mm	13.00mm	32.00mm	18.00mm	3.50mm	M8 x 1.25	453.00 kg	.0487 kg
65-2190	M		32.00mm	16.00mm	51.00mm	22.00mm	4.00mm	M10 x 1.50	1701.00 kg	.1049 kg
65-2200	M		48.00mm	19.00mm	51.00mm	29.00mm	5.50mm	M12 x 1.75	2268.00 kg	.2183 kg
65-2213	M		64.00mm	22.00mm	51.00mm	32.00mm	8.00mm	M16 x 2.00	2721.00 kg	.4490 kg
65-2202	M		76.00mm	27.00mm	51.00mm	38.00mm	10.00mm	M20 x 2.50	3357.00 kg	.7580 kg

Material Specifications

Material	Grade	Process	Finish
Steel	12L14	Machined	Zinc

Required Machining Services

Machining Type	Machined	Reference Page
Tap Profile End	Mounting Profile	861

