

Part Description:

The magnetic door catch is lightweight and ideal for latching plastic panels in place. It has an estimated pull force of 12 pounds (5.443 kilograms). All of the mounting hardware is included for use with a panel. The magnetic door catch requires a panel tap service to mount the striker plate to the plastic panel (page 905).

Tip: Use the magnetic door catch bracket (page 580) to latch a profile to a profile, and refer to the suggested hardware below.

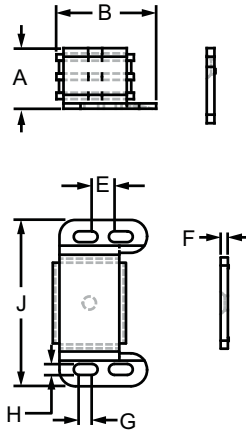

Part No.	Series	Material	Finish	Process	A	B	C	D	E	F	G	H	J	Weight
2090	10 15	Steel	Bright Zinc	Formed	.710"	1.172"	.880"	1.130"	.275"	.090"	.163"	.135"	2.060"	.141 lb
65-2090	25 30 40				18.03mm	29.78mm	22.35mm	28.70mm	6.99mm	2.29mm	4.13mm	3.43mm	52.32mm	.0680 kg
9315	QF				.710"	1.172"	.880"	1.130"	.275"	.090"	.163"	.135"	2.060"	.123 lb

Required Machining Services

Machining Type	Part Machined	Reference Page
Tap	Panel	905

Included Hardware (Mount to T-Slot)

Part No.	Series	Qty.	Description
3005	10 15 25 30 40	2	8-32 x 3/8" BHSCS
3275	10 15 25 30 40	2	Slide-In Economy T-Nut
9325	QF	2	1/4-14 x 3/4" SDS

Included Hardware (Mount Striker Plate to Panel)

Part No.	Series	Qty.	Description
209002	10 15 25 30 40 QF	1	6-32 x 3/8" FHSCS

Suggested Hardware (Mount Striker Plate to Profile)

Series	Part No.	Qty.	Bolt	Part No.	Qty.	T-Nut
10 25	11-4710	1	M4 x 10mm FHSCS	14164	1	Drop-in
15 40	11-4710	1	M4 x 10mm FHSCS	13113	1	Drop-in

