

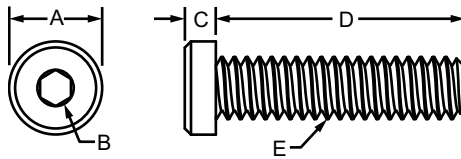

80/20[®] Inc. Low Head Socket Cap Screw / Flanged Hex Head Bolt

Low Head Socket Cap Screw (LHSCS)



Black Zinc

Blue Zinc



Part No.	Series	Material	Finish	A	B	C	D (Length)	E (Thread)	Thread Length	Weight
3017	F	Steel	Black Zinc	.372"	1/8	.124"	1.000"	1/4-20	Full Thread	.013 lb
3018	F		Black Zinc	.434"	5/32	.155"	1.250"	5/16-18	Full Thread	.026 lb
13-1993	M		Blue Zinc	10.00mm	5.00mm	4.00mm	10.00mm	M6 x 1.0	Full Thread	.0036 kg
13-1957	M		Blue Zinc	13.00mm	6.00mm	5.00mm	16.00mm	M8 x 1.25	Full Thread	.0090 kg
11-2525	M		Black Zinc	18.00mm	8.00mm	8.00mm	25.00mm	M12 x 1.75	Full Thread	.0279 kg

Flanged Hex Head Bolt (FHFB)

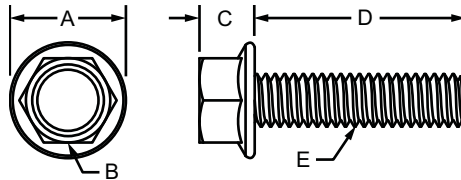

Bright Zinc



Part No.	Series	Material	Finish	A	B	C	D (Length)	E (Thread)	Thread Length	Weight
3747	F	Steel	Bright Zinc	.680"	1/2	.320"	.500"	5/16-18	Full Thread	.025 lb
3748	F			.680"	1/2	.320"	.750"	5/16-18	Full Thread	.027 lb
3749	F			.680"	1/2	.320"	1.000"	5/16-18	Full Thread	.029 lb
3750	F			.680"	1/2	.320"	1.250"	5/16-18	Full Thread	.038 lb
3751	F			.680"	1/2	.320"	1.500"	5/16-18	Full Thread	.043 lb
3752	F			.680"	1/2	.320"	1.750"	5/16-18	Full Thread	.044 lb
3753	F			.680"	1/2	.320"	2.000"	5/16-18	Full Thread	.049 lb
3754	F			.680"	1/2	.320"	2.250"	5/16-18	Full Thread	.052 lb
3755	F			.680"	1/2	.320"	3.500"	5/16-18	Full Thread	.075 lb
13-3753	M		Bright Blue Zinc	17.40mm	12.00mm	8.10mm	50.00mm	M8 x 1.25	22.00mm	.0249 kg