

1010 Profile

1010 is a 1.00" x 1.00" fractional 10 series square T-slot profile with four open T-slots, one on each 1.00" face. The profile has align-a-grooves to assist in aligning connecting profiles. The 1010 profile is compatible with all 10 series fasteners. This profile lends itself to machine guards, sound enclosures, work benches, panel mount racks and displays. The four open T-slots enable access from any direction and are useful for mounting accessories.

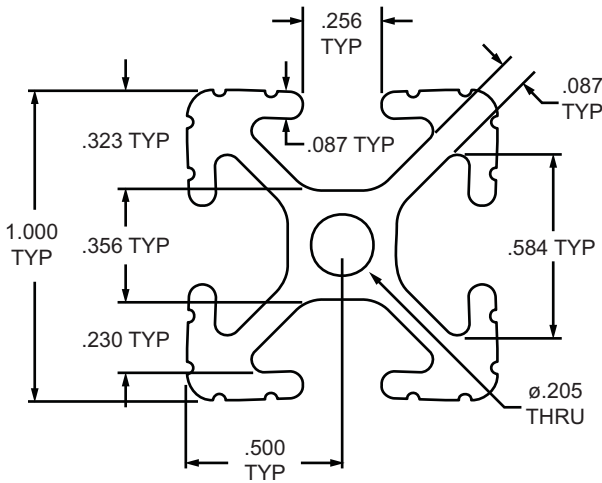

Part No.	Series	Stock Length	Material	Alloy**	Finish	Drop Lock	Moment of Inertia	Surface Area	Yield Strength	Modulus of Elasticity	Weight
1010 *	10	97", 145", 242"	Aluminum	6105-T5	Clear Anodize	2"	IX = 0.0442 ^{m4} IY = 0.0442 ^{m4}	0.435 in. ²	35,000 psi	10,200,000 lb / in. ²	0.0424 lb / in.
1010-Black *		145"			Black Anodize						
1010-Black-FB		per inch			Black Anodize						
1010-Yellow *		145"			Yellow Powder Coat						

* The above profiles are sold per inch or stock length.

** Or comparable

Standard Machining Services

Service No.	Series	Service Description	Reference Page
7005	10	Cut to Length	859
7051	10	Access Hole	863
7042	10	Anchor Counterbore	865
7061	10	Tap Profile End	861