



Air Engineering and Supply

2719 East Franklin Avenue, Minneapolis MN 55406

Phone: 800.332.4181 | Fax: 612.332.4184

Twintec:

Represented by Air Engineering and Supply

Components for high performance industrial automation with proven performance for a half century.

With a track record spanning five decades, Air Engineering and Supply has the experience, training and knowledge to provide you with the best solution to your automation and system requirements.

Five State Service When And Where Your Need It. Our most valuable resource is our highly motivated people. With a total staff of 16, including 5 outside sales personnel, you can count on fast, professional attention to your most difficult and your simplest project. Air Engineering and Supply covers the Midwest including Minnesota, North and South Dakota, the Northern counties of Iowa and Western third of Wisconsin.

For fast, professional service please contact us:

Phone: 800.332.4181 Fax: 612.332.4184

www.airengr.com Email info@airengr.com

"BH" SERIES

TWINTEC MULTIPLE TUBE QUICK DISCONNECT WITH THREADED PORTS

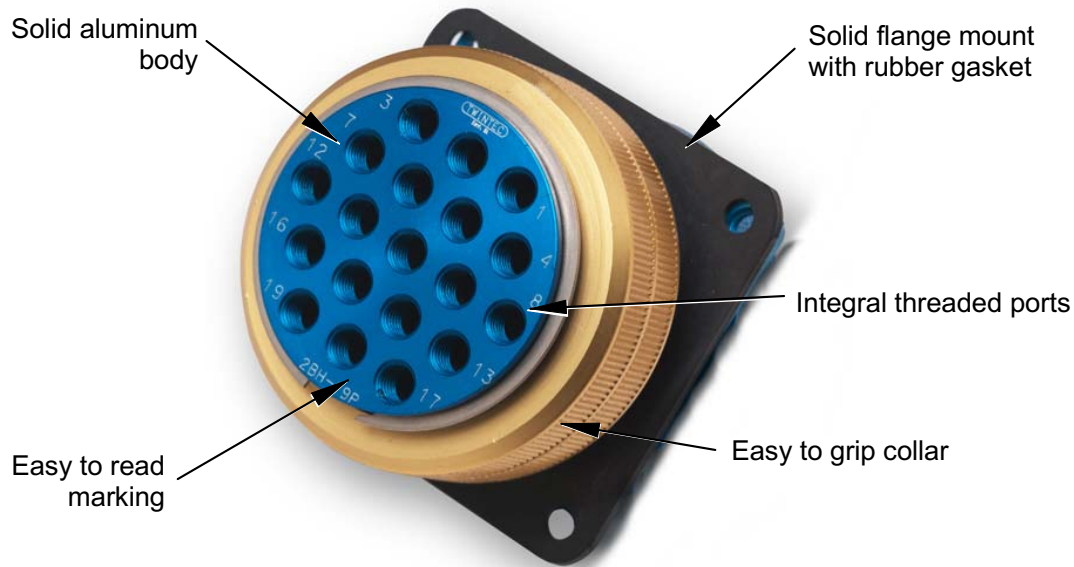

The best way to quick disconnect all of your tubes
in seconds.

With the largest selection of multiple tube connectors, you can connect your tubes in 6 seconds and have the durable good looks of a Twintec connector.

By using our BH series quick disconnect you get the most versatile multiple tube connector available, with the accuracy, reliability and cabinet protection of solid CNC machined aluminum construction.



www.twintecinc.com

1-800-979-9645

"BH" SERIES WITH THREADED PORTS



1BH-7



2BH-19



2.5" SPECIAL



3BH-7

| 1" | | | |
|----|-------|-------|--------|
| # | Type | Dist. | Part # |
| 4 | 10-32 | .42 | 1BH-4 |
| 7 | 10-32 | .30 | 1BH-7 |

Part # is for a complete assembly. For a plug only add a "P" to the end. For a socket only add an "S" to the end.

| 2" | | | |
|----|-------|-------|--------|
| # | Type | Dist. | Part # |
| 8 | 10-32 | .41 | 2BH-8 |
| 12 | 10-32 | .40 | 2BH-12 |
| 16 | 10-32 | .32 | 2BH-16 |
| 19 | 10-32 | .30 | 2BH-19 |

| 2.5" | | | |
|------|----------|-------|----------|
| # | Type | Dist. | Part # |
| 5 | 1/4" NPT | .79 | 2.5BH-5 |
| 9 | 1/8" NPT | .56 | 2.5BH-9 |
| 22 | 10-32 | .30 | 2.5BH-22 |

| 3" | | | |
|----|----------|-------|--------|
| # | Type | Dist. | Part # |
| 7 | 3/8" NPT | .79 | 3BH-7 |
| 8 | 1/4" NPT | .82 | 3BH-8 |

= Number of lines.
Dist. = Port center to center

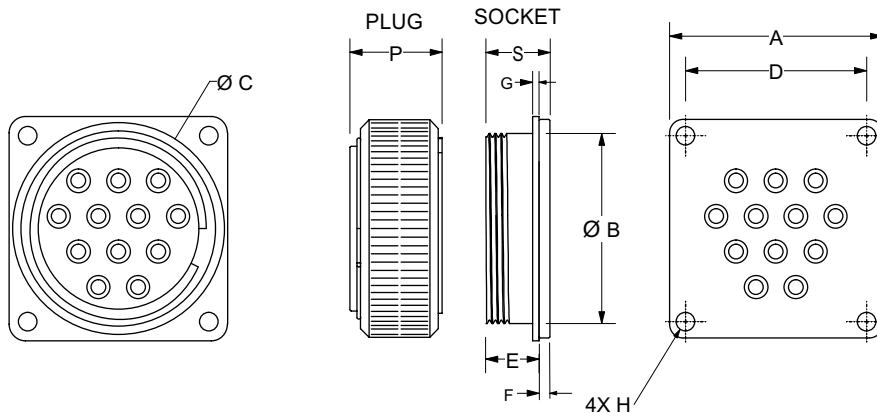

Standard Specifications:

Max. PSI: 125
O-ring: Buna-N
Gasket: EPDM
Body: Aluminum
Finish: Blue and Gold Anodize

| | A | B | C | D | E | F | G | H | P | S |
|-------|------|------|------|-------|------|------|------|-------|------|------|
| 1BH | 1.20 | 1.07 | 1.25 | 0.95 | 0.38 | 0.10 | 0.06 | 0.13 | 0.43 | 0.55 |
| 2BH | 2.00 | 1.75 | 2.00 | 1.70 | 0.50 | 0.10 | 0.06 | 10-32 | 0.87 | 0.60 |
| 2.5BH | 2.50 | 2.25 | 3.50 | 2.125 | 0.50 | 0.14 | 0.06 | 0.18 | 0.65 | 0.79 |
| 3BH | 3.35 | 3.00 | 4.00 | 2.50 | 0.75 | 0.25 | 0.06 | 0.25 | 0.75 | 1.00 |

Fitting alignment for
.30" port spacing
.25" max. hex.

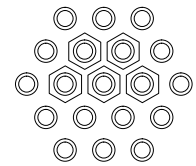

JACKET ADAPTERS

Jacket adapters provide a way to contain the tubing bundle into a jacketing tube for an attractive way to add protection. Works with corrugated hose, smooth tubing or spiral wrapping.

| For all 1" series | | For all 2" series | | For all 3" series | |
|-------------------|--------|-------------------|--------|-------------------|----------|
| Tube ID | Part # | Tube ID | Dash | Tube ID | Dash |
| 0.50 | 1JA-05 | 1.00 | 2JA-10 | 1.00 | 2.5JA-10 |
| 0.75 | 1JA-07 | 1.25 | 2JA-12 | 1.25 | 2.5JA-12 |
| 0.88 | 1JA-08 | 1.50 | 2JA-15 | 1.50 | 2.5JA-15 |

Note: Subtract .10" from the jacket ID to get the bushing ID.



Installation:

Remove collar retaining ring before assembly. Run tubes through jacketing, install bushing into jacket with tubes going through the bushing, press tubes into fittings, sandwich plug body and jacket bushing between shell halves. Tighten two screws alternately until plug and bushing won't spin. Use a wire tie or hose clamp to fix jacketing onto bushing.

Use Part # FD-25, .25" Fitting driver

Special port and line configurations welcome.

Visit our website or call toll free. Available with integral fittings - see our "BC" series.

www.twintecinc.com 1-800-979-9645

19639 70th Ave. So., Kent WA 98032-1138